



£2,500 PCM

Hunton Street, Spitalfields, London. E1

Flat | 3 Bedrooms | 1 Bathroom



Step Inside

Key Features

- Three double bedrooms
- Large private garden
- Fully integrated kitchen
- Wood flooring throughout
- Double glazed
- Gas central heating
- Furnished
- Less than ten-minute walk to Shoreditch High Street station
- Excellent transport links
- Available Now

Property Description

View Properties are pleased to offer this three double bedroom flat in the heart of Spitalfields, moments from Shoreditch and the City. The accommodation is offered furnished and comprises: Entrance hall; modern fully integrated kitchen; one modern bathroom, three double bedrooms, and large private garden. Hunton Street is ideally located for those looking to be in the heart of the action yet within a short walk to the office or of study. The local areas of Spitalfields, Shoreditch, and Hoxton offer a wide array of restaurants, bars, and nightlife. Transport links are also ideal with Shoreditch, Liverpool Street, and Aldgate East Stations close by for easy access to the City, Canary Wharf, and the West End.

Main Particulars

View Properties are pleased to offer this three double bedroom flat in the heart of Spitalfields, moments from Shoreditch and the City. The accommodation is offered furnished and comprises: Entrance hall; modern fully integrated kitchen; one modern bathroom, three double bedrooms, and large private garden.

Hunton Street is ideally located for those looking to be in the heart of the action yet within a short walk to the office or of study. The local areas of Spitalfields, Shoreditch, and Hoxton offer a wide array of restaurants, bars, and nightlife. Transport links are also ideal with Shoreditch, Liverpool Street, and Aldgate East Stations close by for easy access to the City, Canary Wharf, and the West End.



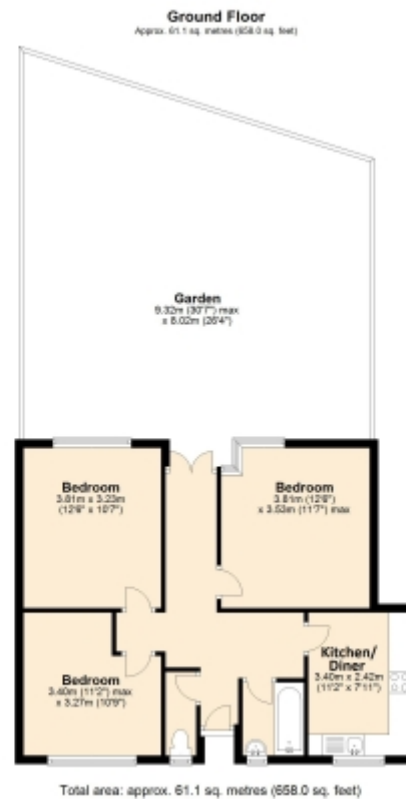

This floorplan is for illustrative purposes only and the location of doors, windows and other items are approximate.

Agents notes: All measurements are approximate and for general guidance only and whilst every attempt has been made to ensure accuracy, they must not be relied on. The fixtures, fittings and appliances referred to have not been tested and therefore no guarantee can be given that they are in working order. Internal photographs are reproduced for general information and it must not be inferred that any item shown is included with the property. Copyright © 2024 00337388 Property Office Ltd. All rights reserved. 17.5.24. 61.1 sq. metres (658.0 sq. feet) 51.68 sq. metres (556.0 sq. feet)

Telephone: 0203 689 0332



www.viewpropertiesuk.com