



£2,800 PCM

Meath Road, Stratford, London. E15

Terraced House | 4 Bedrooms | 1 Bathroom

0203 689 0332



www.viewpropertiesuk.com



Step Inside

Key Features

- Four double bedrooms
- Guest cloakroom
- Wood flooring throughout
- Double glazed
- Gas central heating
- Private garden
- Part furnished
- On street/residents parking
- Excellent transport links
- Available Now

Property Description

Spacious four-bedroom mid-terrace house moments away from Plaistow Station. The accommodation is offered part-furnished and comprises: Entrance hall; a reception room leading to a fitted kitchen with appliances, four double bedrooms; one bathroom with three piece suite; a guest cloakroom and a good size rear garden. On-street parking is available through the local council. Meath Road is found within an easy distance to the Westfield shopping mall, Olympic Park, and other local amenities in Stratford. Excellent transport links include Plaistow Station, West Ham Station, and Stratford Station. Council Tax Band: C EPC: D

Main Particulars

Spacious four-bedroom mid-terrace house moments away from Plaistow Station. The accommodation is offered part-furnished and comprises: Entrance hall; a reception room leading to a fitted kitchen with appliances, four double bedrooms; one bathroom with three piece suite; a guest cloakroom and a good size rear garden. On-street parking is available through the local council.

Meath Road is found within an easy distance to the Westfield shopping mall, Olympic Park, and other local amenities in Stratford. Excellent transport links include Plaistow Station, West Ham Station, and Stratford Station.

Council Tax Band: C

EPC: D



Meath Road Stratford, E15 3DR
Approx. Gross Internal Area 883 Sq Ft - 82.03 Sq M

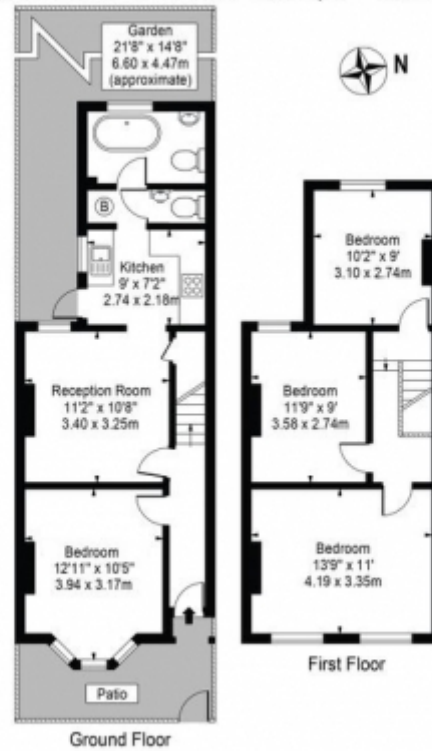

This floorplan is for illustrative purposes only and the location of doors, windows and other items are approximate.

Telephone: 0203 689 0332



www.viewpropertiesuk.com