



£2,100 PCM

Fashion Street, Spitalfields, London. E1

Flat | 2 Bedrooms | 1 Bathroom



Step Inside

Key Features

- Including bills (gas & water)
- Two double bedrooms (equal size)
- Wood flooring throughout
- Ample storage space
- Approx. 680 sq. ft.
- Furnished
- Less than 10 minute walk to Liverpool Street station
- Excellent transport links
- Available 1st April

Property Description

****Including gas and water bills**** A modern two-bedroom secure ground floor flat in the heart of Spitalfields, moments from Brick Lane and the City. The accommodation is offered furnished and comprises: Entrance hall; spacious combined living area and fully integrated kitchen; modern bathroom and two double bedrooms (equal size). Fashion Street is ideally located for those looking to be in the heart of the action yet within a short walk to the Office or place of study. The local areas of Shoreditch, Spitalfields, and Brick Lane offer a wide array of restaurants, bars, and nightlife. Transport links are also ideal with Shoreditch, Liverpool Street, and Aldgate East Stations close by for easy access to the City, Canary Wharf, and the West End. Council Tax Band: C EPC: C

Main Particulars

****Including gas and water bills****

A modern two-bedroom secure ground floor flat in the heart of Spitalfields, moments from Brick Lane and the City. The accommodation is offered furnished and comprises: Entrance hall; spacious combined living area and fully integrated kitchen; modern bathroom and two double bedrooms (equal size).

Fashion Street is ideally located for those looking to be in the heart of the action yet within a short walk to the Office or place of study. The local areas of Shoreditch, Spitalfields, and Brick Lane offer a wide array of restaurants, bars, and nightlife. Transport links are also ideal with Shoreditch, Liverpool Street, and Aldgate East Stations close by for easy access to the City, Canary Wharf, and the West End.

Council Tax Band: C

EPC: C

Deposit: £2,423.00



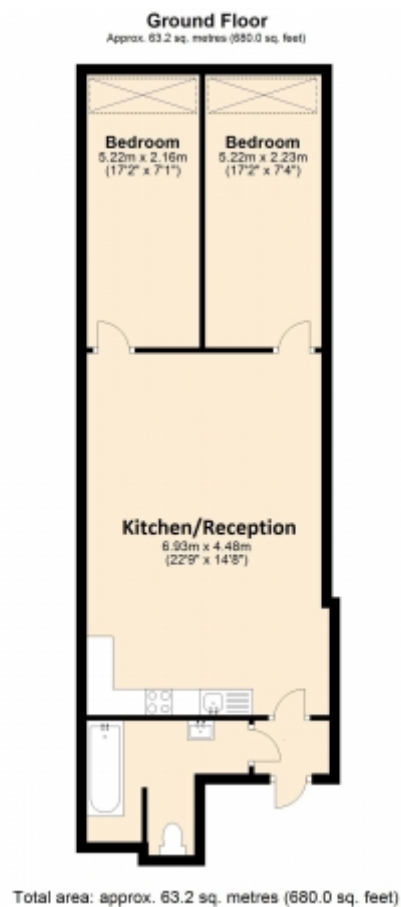

This floorplan is for illustrative purposes only and the location of doors, windows and other items are approximate.

Telephone: 0203 689 0332



www.viewpropertiesuk.com